

SC 18/21/1064

SOUTHAMPTON CITY COUNCIL

TOWN AND COUNTRY PLANNING

GENERAL DEVELOPMENT ORDER 1988 (AS AMENDED)

WHEREAS the Council of the City of Southampton are satisfied that it is expedient that development of the descriptions set out in the schedule hereto should not be carried out on the land shown edged black on Plan No 6693 and on Plan No 7303 (except on that part hatched black) both of which are annexed hereto unless permission therefore is granted or application made under the Town and Country Planning General Development Order 1988 (as amended).

NOW THEREFORE the said Council in pursuance of the powers conferred upon them by Article 4 of the Town and Country Planning General Development Order 1988 (as amended) HEREBY DIRECTS that the permission granted by Article 3 of the said Order shall not apply to development on the said land of the descriptions set out in the Schedule hereto.

The Common Seal of Southampton City  
Council was hereunto affixed in the presence of:

70065

J. A. Pattison

Authorised Signatory

15th May 1992

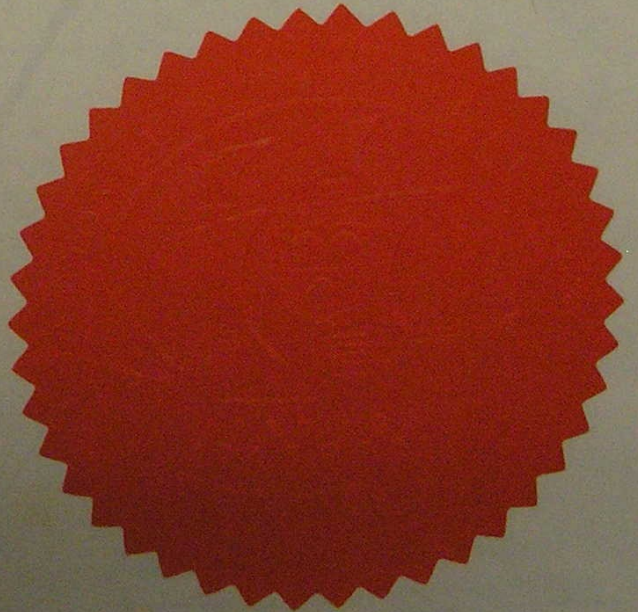



SC 18/21/1064





Area subject to proposed Article 4 direction

As reproduced from the Ordnance Survey, with the addition of the Council's own information. Crown Copyright reserved. City Planning Department, Southampton.

 FLATS (not subject to proposed Article 4 direction)  
 Conservation area boundary



D. I. Wark MRTPI ARIBA  
 Director of Strategy and Development  
 Southampton City Council  
 Civic Centre  
 Southampton SO9 4WY  
 Tel: 0703 223855

Plan No. 6693  
 Scale \_\_\_\_\_  
 Date 11.9.89  
 Drawn MR



Title  
 PROPOSED ARTICLE 4  
 DIRECTION  
 UPLANDS ESTATE.

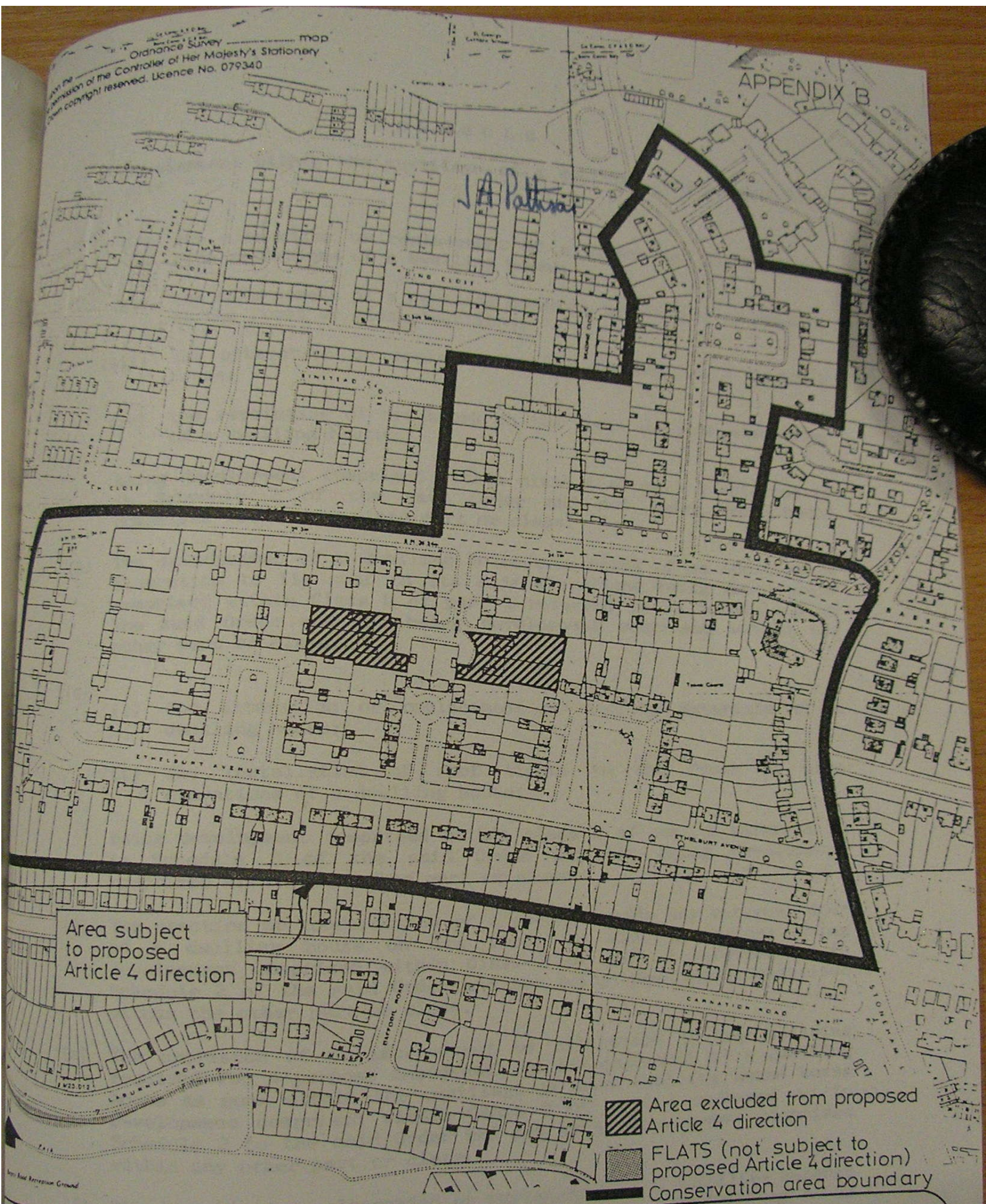

*J.A. Pothier*



Area subject to proposed Article 4 direction

-  Area excluded from proposed Article 4 direction
-  FLATS (not subject to proposed Article 4 direction)
-  Conservation area boundary



D. I. Wark MRTPI ARIBA  
 Director of Strategy and Development  
 Southampton City Council  
 Civic Centre  
 Southampton SO9 4WY  
 Tel: 0703 223855

Plan No. 7303  
 Scale \_\_\_\_\_  
 Date Nov '91  
 Drawn D.B.

PROPOSED ARTICLE 4 DIRECTION  
 ETHELBURT AVENUE



## SCHEDULE

Development within the curtilage of a dwelling house consisting of:-

- (a) *The enlargement, improvement or other alteration of a*  
(i) ~~the alteration or replacement of a window to the front or side elevations of a dwelling house;~~  
*dwellinghouse on its front or side elevations*  
(ii) ~~the enlargement of a dwelling house by addition or alteration to the front or side elevations;~~  
(iii) ~~the alteration or replacement of a chimney of a dwelling house;~~  
(iv) ~~the repointing of brickwork on the front or side elevations of a dwelling house;~~

being development comprised within class A of part 1 referred to in Schedule 2 of the said Order and not being development comprised within any other part or class.

- (b) ~~The enlargement of a dwelling house consisting of an addition or alteration to its roof on its side elevations being development comprised within Class B of part 1 referred to in Schedule 2 to the said Order and not being development comprised within any other part or class.~~

- b*  
(c) *Any alterations to the roof of a dwelling house on its*  
(i) ~~The alteration or replacement of roofing materials of a dwelling house;~~ *front or side elevations*  
(ii) ~~The installation of roof lights to the front or side elevations of a dwelling house;~~

being development comprised within class C of part 1 referred to in Schedule 2 of the said Order and not being development comprised within any other part or class.

- c*  
(d) The erection or construction of a porch outside any external door of a dwelling house on its front or side elevations being development comprised within Class D of part 1 referred to in Schedule 2 of the said Order and not being development comprised within the other part or class.

- d*  
(e) ~~The provision of or improvement or alteration to any building required for a purpose incidental to the enjoyment of a dwelling house as such within the curtilage of that dwelling house being development comprised within Class E of part 1 referred to in Schedule 2 to the said Order and not being development comprised within any other part or class.~~  
*within the curtilage of a dwellinghouse of any building or enclosure, swimming or other pool required for a purpose incidental to the enjoyment of the dwellinghouse, or the maintenance, improvement or other alteration of such a building or enclosure being*

- e*  
(f) The installation, alteration or replacement of a satellite antenna on a dwelling house or within the curtilage of a dwelling house being development comprised within Class H of part 1 referred to in Schedule 2 to the said Order and not being development comprised within any other part or class.



The Secretary of State for the Environment hereby approves the foregoing direction subject to the modifications shown in red ink thereon.

*J A Bridges*

Signed by authority  
of the Secretary of  
State

*1st July 1992*

\*An Assistant  
Secretary in the  
Department of the  
Environment

51/61/8178